



SHOWER BASES
cast acrylic | AcrylX™ | solid surface



PRAXIS

Praxis Makes Perfect
www.praxiscompanies.com

SHOWER BASES AcrylX™ | solid surface | cast acrylic

PG 2 **AcrylX™** patent pending technology

PG 12 **MY PLACE** barrier free accessible & code compliant shower bases

PG 20 **CAST ACRYLIC** thermal cast acrylic

PG 22 **WATER RETAINMENT** accessories

PG 23 **THRESHOLD** details

PG 24 **EASYBASE™** information

WARRANTY

Cast acrylic bases are warranted for five years.
AcrylX™ bases have a lifetime limited warranty.
CenturyStone™ Solid Surface bases are warranted for ten years.

For custom installations, consult with your builder or contractor.

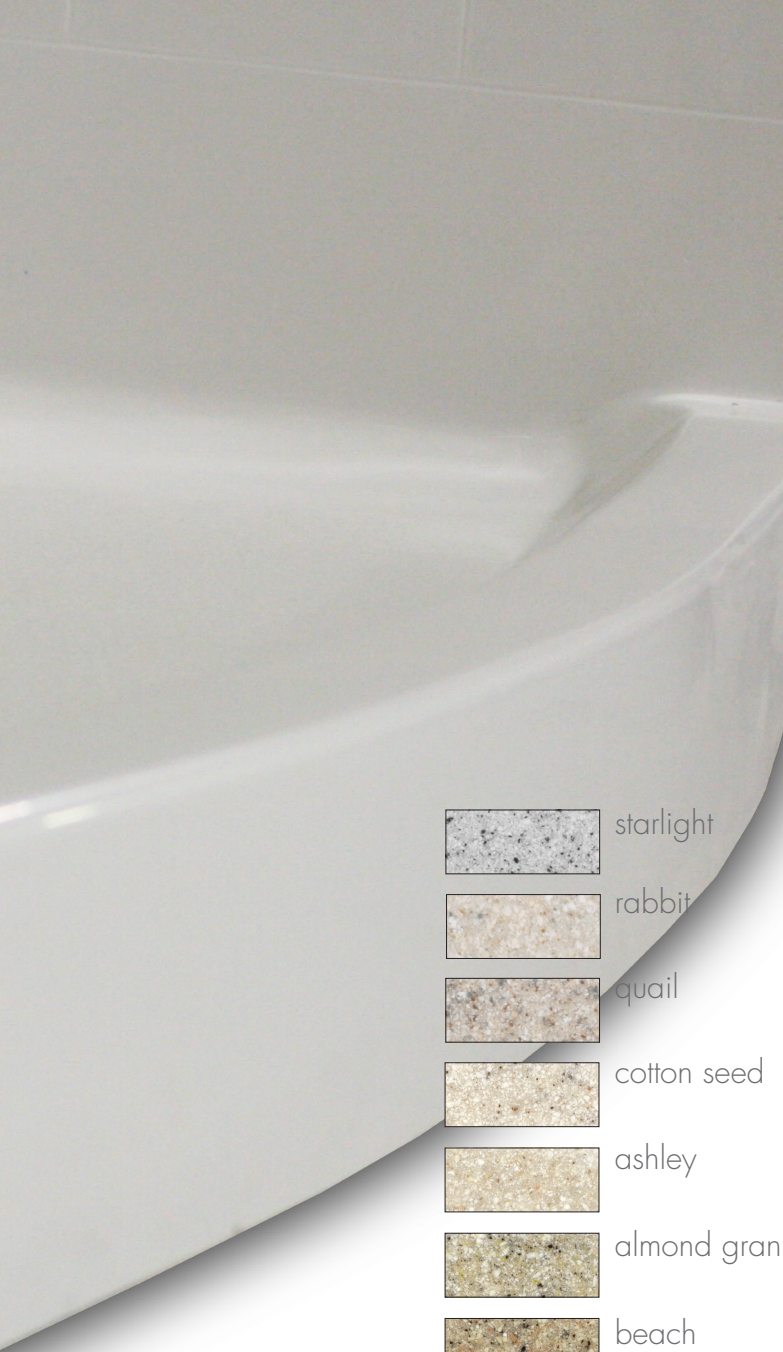

THE PERFECT COMPLIMENT for tile or marble

**Strong, Long Lasting,
Seamless, Non-Porous,
Ten Year Limited Warranty**



MPB 6030 BF shown in CenturyStone™ solid surface NATURALS cotton seed

-  starlight
 -  rabbit
 -  quail
 -  cotton seed
 -  ashley
 -  almond granite
 -  beach
 -  dune
 -  mink
 -  violet
 -  coco
- CenturyStone™ NATURALS
-  white
 -  biscuit
 -  bone
- CenturyStone™ SOLIDS

upgrade to **SOLID SURFACE**

CenturyStone™ solid surface finishes are offered in white, bone or biscuit to compliment any interior design scheme.

CenturyStone™ solid surface goes one step beyond and is offered in granite NATURALS seamless simulated solid surface finishes.

Solid surface shower bases are beautifully designed in CenturyStone™ solid surface, and are the perfect compliment for tile or marble.

APPEAL Renewable solid surface is easy to clean. Solid surface is seamless, durable and the non-porous surface resists stains and odors.

ADVANTAGES Praxis quality construction, traditional bath replacement sizes, shower bases available as left, right or center drain units, and a double entry base unit, barrier free and low threshold EasyStep bases available with No-Flex™ bottoms.

EASY INSTALLATION no mud set required with EasyBase™ factory reinforced, self-sustaining shower base - available on barrier free bases only.

WARRANTY CenturyStone™ solid surface bases have a ten year limited warranty

NOTE: Solid Surface upgrade is available for AcrylX™ bases only.



AcrylX™ shower bases



AcrylX™ SHOWER BASES

AcrylX™ finishes offered standard in white, bone or biscuit to compliment any interior design scheme. Solid Surface is available as an upgrade.



AcrylX™ shower bases are beautifully designed utilizing Patent Pending technology, and are the perfect compliment for tile or marble.

APPEAL The superior finish of AcrylX™ has a visibly true white, deep lustrous finish to better match white porcelain fixtures- providing a more aesthetic appeal to bathrooms. AcrylX™ product will resist scratching, cracking and chipping and will maintain a “factory-new” finish over its lifetime. This means a more beautiful bathroom for years to come.

ADVANTAGES Praxis quality construction, traditional bath replacement sizes, shower bases available as left, right or center drain units, and a double entry base units with low threshold EasyStep™ bases available with No-Flex™ bottoms.

WARRANTY AcrylX™ bases have a lifetime limited warranty.



G 3232 SH PAN 32" x 32" x 6"

AcryIX™ shower base with EasyStep™ 5" threshold.

HANDED center drain

WEIGHT 50

CODES ANSI Z 124.2



G 3248 SH PAN 32" x 48" x 6"

AcryIX™ shower base with EasyStep™ 5" threshold.

HANDED center drain

WEIGHT 60

CODES IPC, UPC, ANSI Z 124.2



G 3442 SH PAN 34" x 42" x 6"

AcryIX™ shower base with EasyStep™ 5" threshold.

HANDED center drain

WEIGHT 56

CODES IPC, UPC, ANSI Z 124.2



G 3636 SH DE PAN 36" x 36" x 6"

Double entry AcryIX™ shower base with EasyStep™ 5" threshold.

HANDED entry side- front left or front right

WEIGHT 60

CODES IPC, UPC, ANSI Z 124.2

upgrade to **SOLID SURFACE**

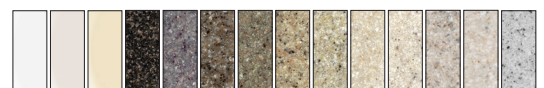

AcrylX™ shower bases



G 3636 SH PAN 36" x 36" x 6"

AcrylX™ shower base with EasyStep™ 5" threshold.

HANDED center drain

WEIGHT 60

CODES IPC, UPC, ANSI Z 124.2



G 3648 SH PAN 36" x 48" x 6"

AcrylX™ shower base with EasyStep™ 5" threshold.

HANDED center drain

WEIGHT 65

CODES IPC, UPC, ANSI Z 124.2



G 3838 NA PAN 38" x 38" x 6"

Neo-angle AcrylX™ shower base with EasyStep™ 5" threshold.

HANDED center drain

WEIGHT 68

CODES IPC, UPC, ANSI Z 124.2



G 4232 SH PAN 42" x 32" x 6"

AcrylX™ shower base with EasyStep™ 5" threshold.

HANDED center drain

WEIGHT 56

CODES IPC, UPC, ANSI Z 124.2



G 4234 SH PAN 42" x 34" x 6"

AcryIX™ shower base with EasyStep™ 5" threshold.

HANDED center drain

WEIGHT 56

CODES IPC, UPC, ANSI Z 124.2



G 4236 SH DE PAN 42" x 36" x 6"

Double entry AcryIX™ shower base with EasyStep™ 5" threshold.

HANDED entry side- front left or front right

WEIGHT 60

CODES IPC, UPC, ANSI Z 124.2



G 4236 SH PAN 42" x 36" x 6"

AcryIX™ shower base with EasyStep™ 5" threshold.

HANDED center drain

WEIGHT 60

CODES IPC, UPC, ANSI Z 124.2



G 4242 NA PAN 42" x 42" x 6"

Neo-angle AcryIX™ shower base with EasyStep™ 5" threshold.

HANDED center drain

WEIGHT 70

CODES IPC, UPC, ANSI Z 124.2

upgrade to **SOLID SURFACE**

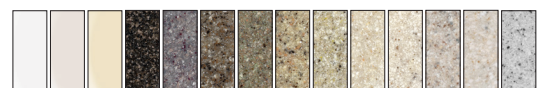

AcryIX™ shower bases



G 4242 SH PAN 42" x 42" x 6"

AcryIX™ shower base with EasyStep™ 5" threshold.

HANDED center drain

WEIGHT 62

CODES IPC, UPC, ANSI Z 124.2



G 4248 SH PAN 42" x 48" x 6"

AcryIX™ shower base with EasyStep™ 5" threshold.

HANDED center drain

WEIGHT 66

CODES IPC, UPC, ANSI Z 124.2



G 4832 SH DE PAN 48" x 32" x 6"

AcryIX™ double entry shower base with 5" EasyStep™ dam.

HANDED entry side- front left or front right

WEIGHT 60

CODES IPC, UPC, ANSI Z 124.2



G 4832 SH PAN 48" x 32" x 6"

AcryIX™ shower base with EasyStep™ 5" threshold.

HANDED center drain

WEIGHT 60

CODES IPC, UPC, ANSI Z 124.2



G 4836 SH PAN 48" x 36" x 6"

AcryIX™ shower base with EasyStep™ 5" threshold.

HANDED center drain

WEIGHT 64

CODES IPC, UPC, ANSI Z 124.2



G 4848 SH PAN 48" x 48" x 6"

AcryIX™ shower base with EasyStep™ 5" threshold.

HANDED center drain

WEIGHT 70

CODES IPC, UPC, ANSI Z 124.2



G 5434 SH PAN 54" x 34" x 6"

AcryIX™ shower base with EasyStep™ 5" threshold.

HANDED center drain

WEIGHT 68

CODES IPC, UPC, ANSI Z 124.2



G 5436 SH DE PAN 54" x 36" x 6"

AcryIX™ double entry shower base with EasyStep™ 5" threshold.

HANDED entry side- front left or front right

WEIGHT 70

CODES IPC, UPC, ANSI Z 124.2

upgrade to **SOLID SURFACE**

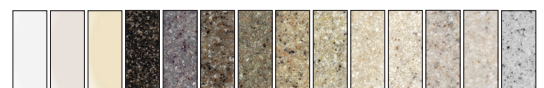

AcryIX™ shower bases



G 6032 SH PAN 60" x 32" x 6"

AcryIX™ shower base with EasyStep™ 5" threshold.

HANDED center drain

WEIGHT 74

CODES IPC, UPC, ANSI Z 124.2



G 6033 SH PAN 60" x 33" x 6"

AcryIX™ shower base with EasyStep™ 5" threshold.

HANDED left or right drain

WEIGHT 74

CODES IPC, UPC, ANSI Z 124.2



G 6036 SH PAN 60" x 36" x 6"

AcryIX™ shower base with 5" EasyStep™ dam.

HANDED center drain

WEIGHT 77

CODES IPC, UPC, ANSI Z 124.2



G 6042 SH PAN 60" x 42" x 6"

AcryIX™ shower base with EasyStep™ 5" threshold.

HANDED center drain

WEIGHT 82

CODES IPC, UPC, ANSI Z 124.2



G 7232 SH PAN 72" × 32" × 6"

AcryIX™ shower base with EasyStep™ 5" threshold.

HANDED center drain

WEIGHT 80

CODES IPC, UPC, ANSI Z 124.2



G 7236 SH PAN 72" × 36" × 6"

AcryIX™ shower base with EasyStep™ 5" threshold.

HANDED center drain

WEIGHT 86

CODES IPC, UPC, ANSI Z 124.2



G 3660 SH IS PAN 36" × 60" × 19"

AcryIX™ shower base with one seat and 5" EasyStep™ threshold.

HANDED center drain

WEIGHT 76

CODES IPC, UPC, ANSI Z 124.2



G 3842 SH 2S PAN 38" × 42" × 23"

AcryIX™ shower base with two seats and 5" EasyStep™ threshold.

HANDED center drain

WEIGHT 86

CODES IPC, UPC, ANSI Z 124.2

upgrade to **SOLID SURFACE**

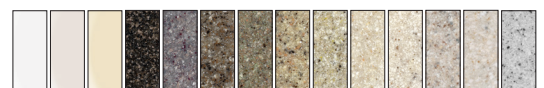

AcryIX™ shower bases



G 4836 SH IS PAN 48" x 36" x 19"

AcryIX™ shower base with one seat and 5" EasyStep™ threshold.

HANDED seat

WEIGHT 84

CODES IPC, UPC, ANSI Z 124.2



G 6036 SH IS PAN 60" x 36" x 19"

AcryIX™ shower base with one seat and 5" EasyStep™ threshold.

HANDED seat

WEIGHT 97

CODES IPC, UPC, ANSI Z 124.2



G 6060 NA IS PAN 60" x 60" x 19"

AcryIX™ neo-angle shower base with one seat and 5" EasyStep™ threshold.

HANDED center drain

WEIGHT 96

CODES IPC, UPC, ANSI Z 124.2



G 7236 SH IS PAN 72" x 36" x 19"

AcryIX™ shower base with one seat and 5" EasyStep™ threshold.

HANDED seat

WEIGHT 96

CODES IPC, UPC, ANSI Z 124.2



G 7239 SH IS PAN 72" x 39" x 19"

AcrylX™ shower base with one seat and 5" EasyStep™ threshold.

HANDED seat

WEIGHT 101

CODES IPC, UPC, ANSI Z 124.2



upgrade to **SOLID SURFACE**

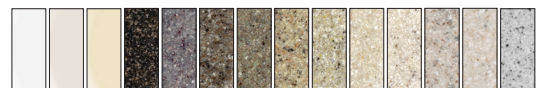

SAFE. ACCESSIBLE.
BATHING SOLUTIONS.

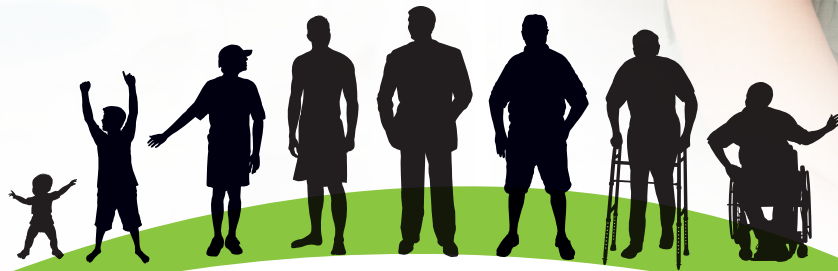

MyPlace™ AcrylX™ shower bases



ACCESSIBLE SHOWER BASES

AcrylX™ finishes are offered in white, bone or biscuit to compliment any interior design scheme. Solid Surface is available as an upgrade.



APPEAL A new collection of classically styled shower pans offers a realistic approach towards renovation with a focus on accessibility.

The Praxis My Place shower base collection is designed for those who value independence- no matter what your place in your life.

With the Praxis My Place collection, you can have the best of both worlds - beauty and safety- bathware that makes living life easier.

ADVANTAGES Praxis quality construction, traditional bath replacement sizes, shower bases available as left, right or center drain units, and a double entry base unit, barrier free and low threshold EasyStep™ bases available with No-Flex™ bottoms.

EASY INSTALLATION no mud set required with EasyBase™ factory reinforced, self-sustaining shower base - *available on barrier free bases only.*

WARRANTY My Place bases have a lifetime limited warranty.



MPB 3838 BF .5 38.625" × 38.4375" × 4.5"
 ADA compliant AcrylX™ shower base with 1/2" barrier free threshold
 HANDED center drain
 WEIGHT 85
 CODES ADA, ICC ANSI, ANSI I 17.1, MAS, TAS



MPB 5430 BF 1.0 L/R 54" × 31" × 4.25"
 AcrylX™ shower base with 1" barrier free change of level.
 Change of level threshold has a manageable 1/4" vertical rise to easily coordinate with minimum finished flooring.

HANDED drain left or right
 WEIGHT 56
 CODES IPC, UPC, ANSI Z 124.2



MPB 5436 BF 1.0 L/R 54" × 36.875" × 4.25"
 AcrylX™ shower base with 1" barrier free change of level.
 Change of level threshold has a manageable 1/4" vertical rise to easily coordinate with minimum finished flooring.

HANDED drain left or right
 WEIGHT 58
 CODES IPC, UPC, ANSI Z 124.2



MPB 6232 BF .75 62.4375" × 32.25" × 4.5"
 AcrylX™ shower base with 3/4" barrier free change of level.
 Change of level threshold has a manageable 1/4" vertical rise to easily coordinate with minimum finished flooring.

HANDED center drain
 WEIGHT 102
 CODES ADA, ICC ANSI, ANSI I 17.1, MAS



upgrade to **SOLID SURFACE**

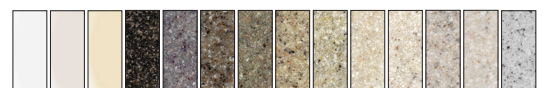

AcryIX™ shower bases



MPB 6232 BF 1.0 LR 62.438" × 32.25" × 4.5"
AcryIX™ shower base with 1" barrier free change of level.
Change of level threshold has a manageable 1/4" vertical rise
to easily coordinate with minimum finished flooring.

HANDED left or right drain
WEIGHT 62
CODES IPC, UPC, ANSI Z 124.2



MPB 6238 BF .75 62.4375" × 38.25" × 4.5"
AcryIX™ shower base with 3/4" barrier free change of level.
Change of level threshold has a manageable 1/4" vertical rise
to easily coordinate with minimum finished flooring.

HANDED center drain
WEIGHT 110
CODES ADA, ICC ANSI, ANSI 117.1, MAS, CAL-24



MPB 4836 BF .875 48" × 37" × 4.5"
AcryIX™ shower base with 7/8" barrier free change of level.
Change of level threshold has a manageable 1/4" vertical rise
to easily coordinate with minimum finished flooring.

HANDED center drain
WEIGHT 96
CODES IPC, UPC, ANSI Z 124.2



MPB 4836 SH 3.0 48" × 37" × 4.5"
AcryIX™ shower base with 3" easy-step dam.

HANDED center drain
WEIGHT 96
CODES IPC, UPC, ANSI Z 124.2



MPB 4848 BF DE 1.0 C 50" x 50" x 4.5"

AcrylX™ double entry shower base with 1" barrier free change of level. Change of level threshold has a manageable 1/4" vertical rise to easily coordinate with minimum finished flooring.

WEIGHT 102

CODES IPC, UPC, ANSI Z 124.2



MPB 5050 BF 1.0 C 50.5" x 50.125" x 4.25"

AcrylX™ shower base with 1" barrier free change of level. Change of level threshold has a manageable 1/4" vertical rise to easily coordinate with minimum finished flooring.

HANDED center drain

WEIGHT 84

CODES IPC, UPC, ANSI Z 124.2



MPB 6030 BF .75 C 60" x 31" x 4.25"

AcrylX™ shower base with 3/4" barrier free change of level. Change of level threshold has a manageable 1/4" vertical rise to easily coordinate with minimum finished flooring.

HANDED center drain

WEIGHT 96

CODES IPC, UPC, ANSI Z 124.2



MPB 6030 BF 1.0 LR 60" x 31" x 4.5"

AcrylX™ shower base with 1" barrier free change of level. Change of level threshold has a manageable 1/4" vertical rise to easily coordinate with minimum finished flooring.

HANDED left or right drain

WEIGHT 96

CODES IPC, UPC, ANSI Z 124.2

upgrade to **SOLID SURFACE**

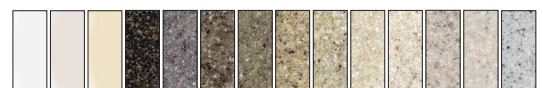

AcrylX™ shower bases



MPB 6030 SH 4.0 LR 60" × 31" × 6"

AcrylX™ shower base with 4" easy-step dam.

HANDED left or right drain

WEIGHT 96

CODES IPC, UPC, ANSI Z 124.2



MPB 6033 BF .75 C 60" × 33.375" × 4.5"

AcrylX™ shower base with 3/4" barrier free change of level.

Change of level threshold has a manageable 1/4" vertical rise to easily coordinate with minimum finished flooring.

HANDED center drain

WEIGHT 96

CODES IPC, UPC, ANSI Z 124.2



MPB 6033 BF 1.0 LR 60" × 33.375" × 4.5"

AcrylX™ shower base with 1" barrier free change of level.

Change of level threshold has a manageable 1/4" vertical rise to easily coordinate with minimum finished flooring.

HANDED left or right drain

WEIGHT 96

CODES IPC, UPC, ANSI Z 124.2



MPB 6036 BF .875 C 60" × 37" × 4.5"

AcrylX™ shower base with 7/8" barrier free change of level.

Change of level threshold has a manageable 1/4" vertical rise to easily coordinate with minimum finished flooring.

HANDED center drain

WEIGHT 103

CODES IPC, UPC, ANSI Z 124.2



MPB 6036 BF 1.0 LR 60" x 36.875" x 4.5"

AcrylX™ shower base with 1" barrier free change of level. Change of level threshold has a manageable 1/4" vertical rise to easily coordinate with minimum finished flooring.

HANDED left or right drain

WEIGHT 103

CODES IPC, UPC, ANSI Z 124.2



MPB 6048 BF .875 60" x 49" x 4.5"

AcrylX™ shower base with 7/8" barrier free change of level. Change of level threshold has a manageable 1/4" vertical rise to easily coordinate with minimum finished flooring.

HANDED center drain

WEIGHT 124

CODES IPC, UPC, ANSI Z 124.2



MPB 6060 BF DE 1.25 61" x 61" x 4.5"

AcrylX™ double entry shower base with 1 1/4" barrier free change of level. Change of level threshold has a manageable 1/4" vertical rise to easily coordinate with minimum finished flooring.

WEIGHT 166

CODES IPC, UPC, ANSI Z 124.2



MPB 6060 BF 1.125 60" x 61" x 4.5"

AcrylX™ shower base with 1 1/8" barrier free change of level. Change of level threshold has a manageable 1/4" vertical rise to easily coordinate with minimum finished flooring.

HANDED center drain

WEIGHT 166

CODES IPC, UPC, ANSI Z 124.2

upgrade to **SOLID SURFACE**

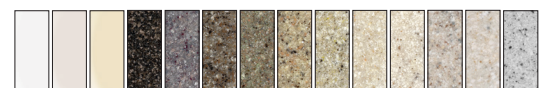

AcrylX™ shower bases

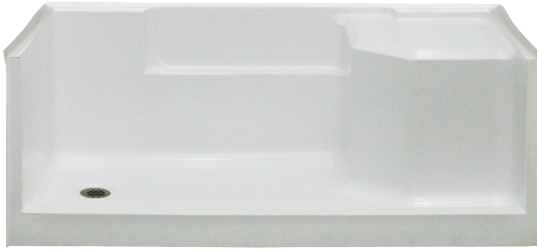

MPB 3260 SH 4.0 60" x 32" x 22"

AcrylX™ shower base with 4" EasyStep™ threshold. Left or right molded seat is at 21" for comfort and compliments the integrated foot ledge.

HANDED left or right seat

WEIGHT 151

CODES IPC, UPC, ANSI Z 124.1



MPB 3060 SH 4.0 60" x 33" x 14"

AcrylX™ shower base with 4" EasyStep™ threshold. Features a stylish bow front and tile pattern on back wall.

HANDED center drain

WEIGHT 96

CODES IPC, UPC, ANSI Z 124.2





MPB 6032 SH IS 4.0 60" × 33" × 27.25"
AcrylX™ shower base with 4" EasyStep™ threshold. Left or right molded seat is at 21" for comfort and compliments the integrated foot ledge. Features tile pattern on back wall.
HANDED left or right seat
WEIGHT 151
CODES ANSI I24.2, UPC, NAHB, CSA



MPB 3648 SH IS 4.0 62.4375" × 32.25" × 22.5"
AcrylX™ shower base with 4" easy step threshold. Left or right sculpted seat is at 21" for comfort and compliments the integrated soap and foot ledge. Features tile pattern on back wall.
HANDED left or right seat
WEIGHT 170
CODES ANSI I24.2, UPC, NAHB, CSA

upgrade to **SOLID SURFACE**

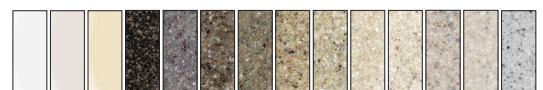



CAST ACRYLIC FINISHES

standard premium cast acrylic finishes are offered in white, bone or biscuit to compliment any interior design scheme.



CAST ACRYLIC shower bases

Cast acrylic shower bases are beautifully designed in high gloss premium thermal cast acrylic, and are the perfect compliment for tile or marble.

APPEAL high gloss cast acrylic is non-porous and easy to clean

ADVANTAGES Praxis quality construction, traditional bath replacement sizes, shower bases available as corner units, left, right or center drain units, and a double base unit, sturdy No-Flex™ bottom

EASY INSTALLATION substantial and durable cast acrylic flanges along with pre-levelled bases and no mud set required

WARRANTY five year limited warranty

AB 3636 shown above in white

CAST ACRYLIC shower bases

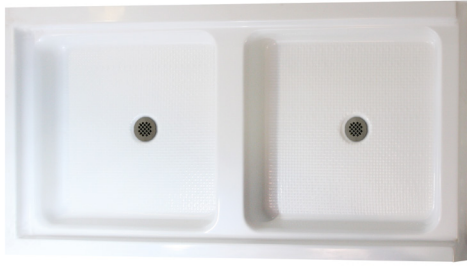

AB 3672 36.25" x 71.75" x 7.125"
acrylic shower double base with 6" Easy-Step™ threshold
HANDED center drain
WEIGHT 68



ABC 3838 38" x 38" x 5.25"
acrylic corner shower base with
4" Easy-Step™ threshold
HANDED center drain
WEIGHT 68

ABC 4242 42" x 42" x 7.25"
acrylic corner shower base with
6" threshold
HANDED center drain
WEIGHT 69



AB 3636 36" x 36" x 7.25"
acrylic shower base with
6" Easy-Step™ threshold
HANDED center drain
WEIGHT 68

AB 4242 42" x 42" x 7.25"
acrylic shower base with
6" Easy-Step™ threshold
HANDED center drain
WEIGHT 67



AB 3448 48" x 34" x 5.25"
acrylic shower base with 4"
Easy-Step™ threshold
HANDED center drain
WEIGHT 67

AB 3460 60" x 34" x 5.25"
acrylic shower base with 4"
Easy-Step™ threshold
HANDED center drain
WEIGHT 81



AB 6032 60" x 32" x 7.25"
acrylic shower base with 6"
Easy-Step™ threshold
HANDED left, right drain
WEIGHT 83

AB 4260 60" x 42" x 6.25"
acrylic shower base with 4"
Easy-Step™ threshold
HANDED center drain
WEIGHT 81

AB 6032 60" x 32" x 7.25"
acrylic shower base with 6"
Easy-Step™ threshold
HANDED center drain
WEIGHT 83

CONTROL WATER SPILLAGE HELP PREVENT FALLS

Preventing water spillage is a must. Safety is increased by retaining water in the shower areas to keep the rest of the area dry. Praxis offers the most effective forms of water retainment - the collapsible dam, semi-permanent dam and weighted shower curtains.



collapsible dam with vertical end caps



collapsible dam self-adhesive



collapsible dam flexes easily



semipermanent dam



premium weighted shower curtain

COLLAPSIBLE DAM with end caps

Designed specifically for barrier-free, curbless showers and shower bases that require water control. When combined with a weighted shower curtain, the flexible collapsible dam prevents water spillage. The collapsible dam collapses easily by foot or wheelchair and returns to the original shape after it has been rolled or stepped on. The collapsible dam size is customized to your shower or base- you cut the strip to the length you need. Self-adhesive, double-sided, water resistant tape on the bottom ensures a secure seal. Praxis collapsible dams are certified bacteria resistant. End caps for showers and bases with radius or square end walls are available.

SEMIPERMANENT DAM

Semipermanent dams are custom made to fit each shower base and are siliconed in place. The semipermanent dam allows for a low step entry into the shower and excellent water spillage protection. Since the dams are siliconed in place, dam can be removed and reused if necessary.

WEIGHTED SHOWER CURTAIN

Premium weighted shower curtains are necessary for a complete water retainment system to work properly. Praxis offers heavy gauge institutional grade shower curtains that contain one inch heavy tape weights embedded in the bottom seam of the curtain. When combined with a collapsible dam or semipermanent dam, the weighted curtain will catch the top of the dam and the curtain will be prevented from blowing out over the dam. The curtains are sized 15% larger than the shower opening for effective containment.

THRESHOLD details

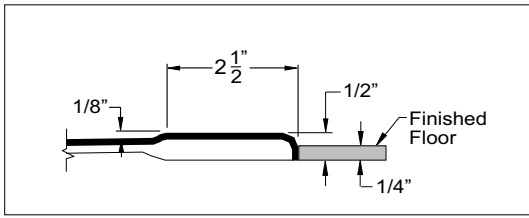

0.5" Barrier Free

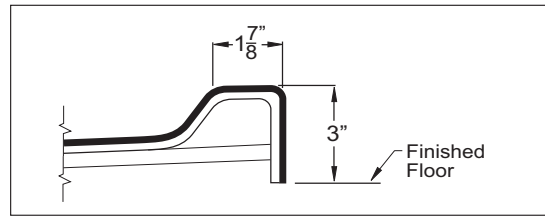

3" EasyStep™

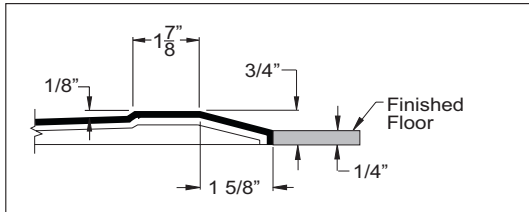

0.75" Change of Level*

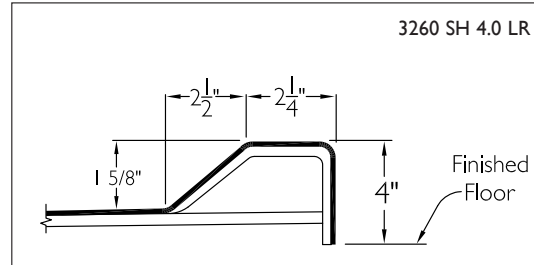

4" EasyStep™

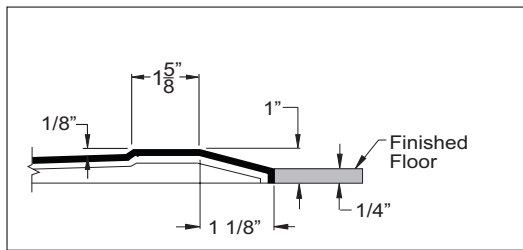

1" Change of Level*

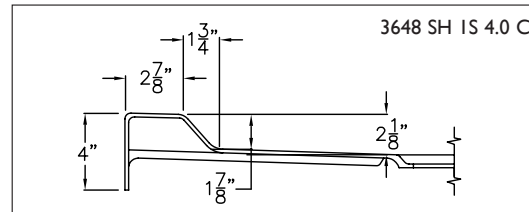

4" EasyStep™

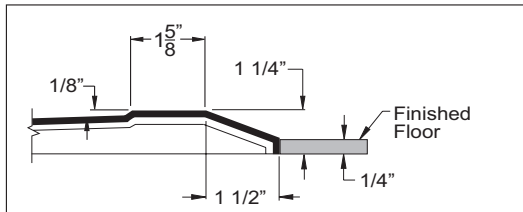

1.25" Change of Level*

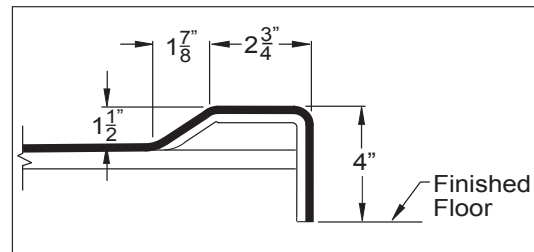

4" EasyStep™

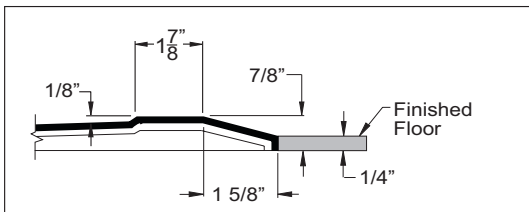

0.875" Change of Level*

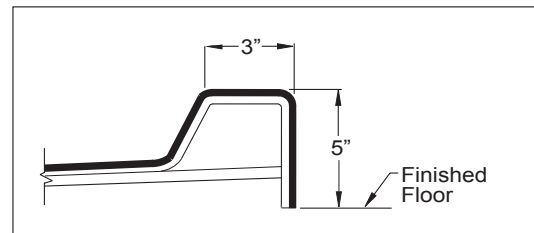

5" EasyStep™

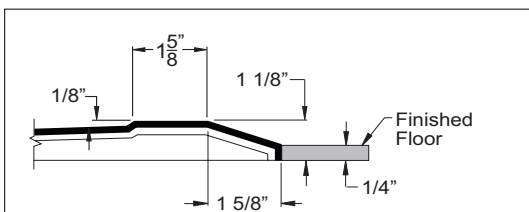

1.125" Change of Level*

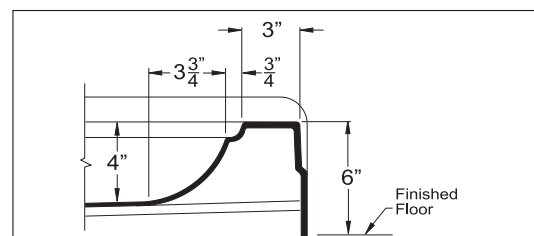

6" EasyStep™

* Change of level threshold has a manageable 1/4" vertical rise to easily coordinate with minimum finished



**easy
Base™**

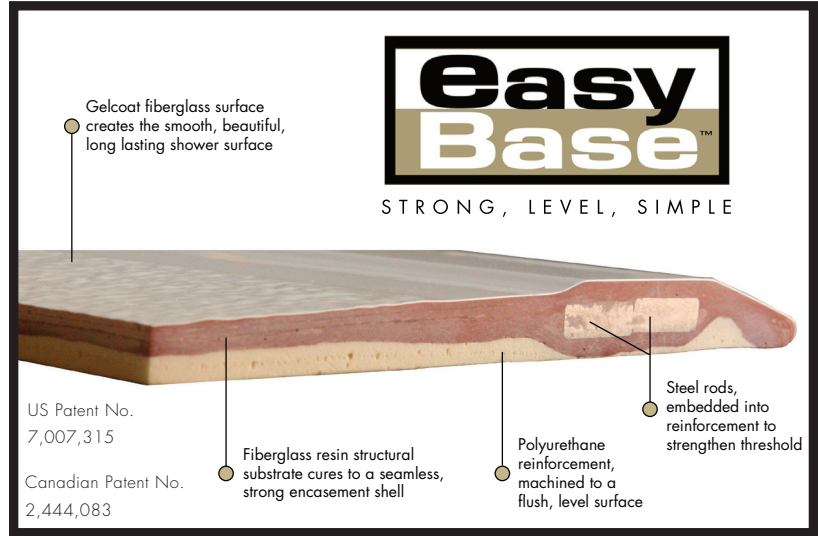

EASYBASE™ - FACTORY REINFORCED SELF-SUSTAINING SHOWER BASE
The Evolution of Strength, Beauty & Simplicity

EASYBASE™

Reduces Installation Risks & Saves Construction Time & Money

- 1 Polyurethane fills contours to solidify bottom of shower unit
- 2 Machined to a flush, level surface
- 3 Minimize risk of soft shower unit bottoms
- 4 Minimize risk of water drainage problems
- 5 Simplify installation
- 6 Reduce installation time by over 50%
- 7 Minimum use of mud (in drain area only)
- 8 Pre-leveled shower unit ready to install on level surface
- 9 Allows for cold weather installation
- 10 US & Canadian Patented sturdy base

EASYBASE™, the patented design process for factory reinforced shower bottoms provides the contractor with a pre-leveled shower unit that is ready to install on a level surface. This problem solving feature is of tremendous benefit to construction plumbers, developers and owners by saving installation time and money, minimizing risk of water drainage problems and soft shower bottoms.

**S T R O N G
L E V E L
S I M P L E**



PRAXIS MAKES YOUR LIFE EASIER

For easy handling, Praxis shower bases come packaged in compact, durable carton boxes that are designed to fit in the back of a pick-up truck or van. All accessories are also packaged separately for easy field installed installation.

PRAXIS SHOWER BASES allow for easy home modification without the sacrifice of beautifully designed and functional bathware.



PRAXIS
Praxis Makes Perfect

SHOWER BASES
cast acrylic | AcrylX™ | solid surface
www.praxiscompanies.com | 800.443.7269



PRAXIS
Praxis Makes Perfect

SHOWER BASES

cast acrylic | AcrylX™ | solid surface
www.praxiscompanies.com | 800.443.7269